

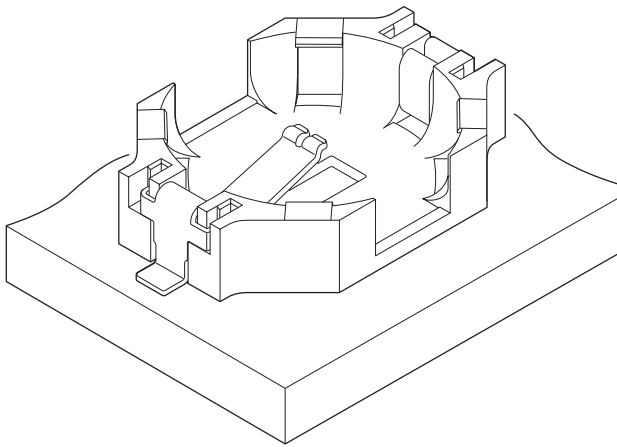

PB CONNECTOR



Connector for button batteries used in the compact mobile equipment such as mobile phones. Mounting cost will be reduced by using this connector in place of manual soldering. And, button batteries can be more easily disassembled after use for recycling's sake.

- Resistant to the shock
- Double contact point

Specifications

- Applicable batteries: 414 type battery/4.8mm dia. × 1.4 height
518 type battery/5.8mm dia. × 1.8 height
614 type battery/6.8mm dia. × 1.4 height
621 type battery/6.8mm dia. × 2.1 height
- Temperature range: -25°C to +85°C
(including temperature rise in applying electrical current)
- Contact resistance: Initial value/100m Ω max.
After environmental testing/120m Ω max.
- Insulation resistance: 1,000M Ω min.
- Withstanding voltage: 500V AC/minute
- * RoHS compliant products are published.
- * Refer to "General Instruction and Notice when using Terminals and Connectors" at the end of this catalog.
- * Contact JST for details.

Standards

Recognized E60389

PC board layout (viewed from component side)

PB-414SR12K-TF

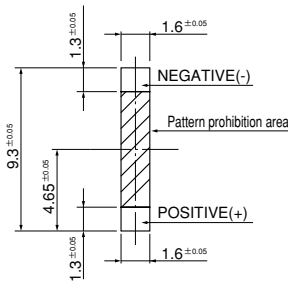

PB-414SS12-TF

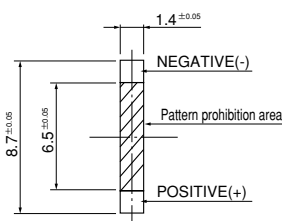

PB-518SR13-TF

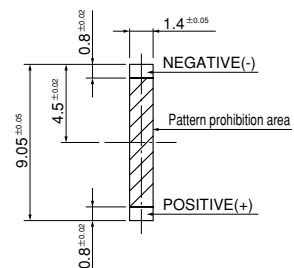

PB-518SW13-TF

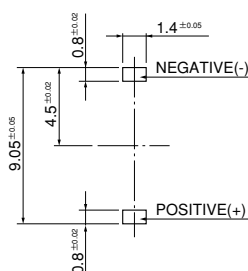

PB-614SS13-TF
PB-621SR13-TF

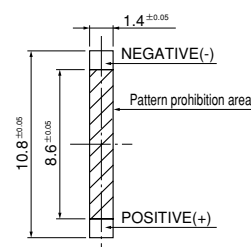

Connector

414 type

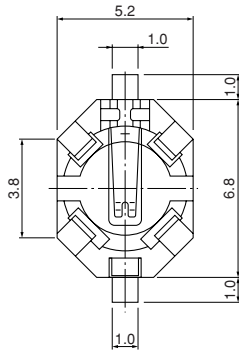

※ The dimension should be measured from housing bottom surface.

414 type/low profile

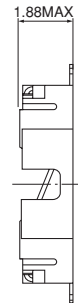
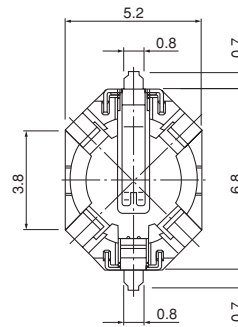

518 type

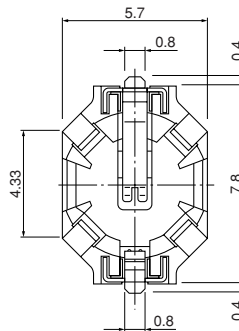

bottom covered

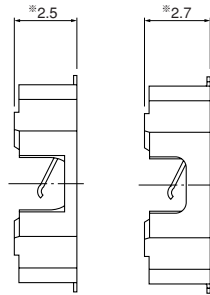

※ The dimension should be measured from housing bottom surface.

614 type

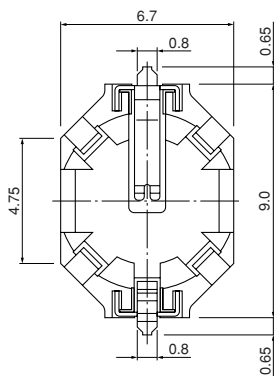

※ The dimension should be measured from housing bottom surface.

621 type

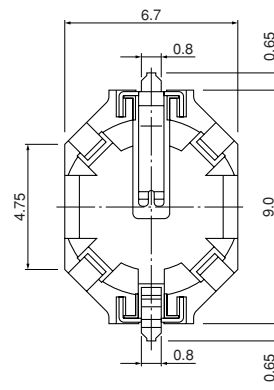

※ The dimension should be measured from housing bottom surface.

Type	Holder part	Model No.	Q'ty/ reel
414	Resin hook	PB-414SR12K-TF	3,000
414/low profile type	Resin hook	PB-414SS12-TF	3,000
518	Resin hook	PB-518SR13-TF	2,000
518/bottom covered	Resin hook	PB-518SW13-TF	2,000
614	Resin hook	PB-614SS13-TF	2,000
621	Resin hook	PB-621SR13-TF	2,000

Material and Finish

Contact: Copper alloy, nickel-undercoated, gold-plated
 Housing: Glass-filled LCP, UL94V-0, natural (ivory), black (414 type)
 Holder contact: Copper alloy, nickel-undercoated, gold-plated (614 type with metal hook)

RoHS compliance

PB CONNECTOR

Taping specifications

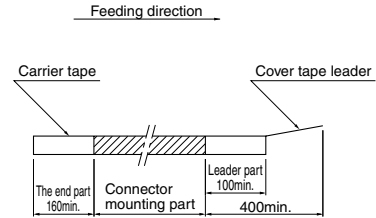
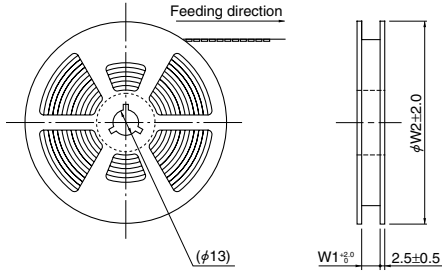

PB-414SR12K-TF

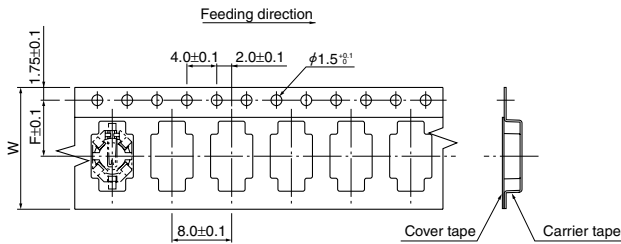

PB-414SS12-TF

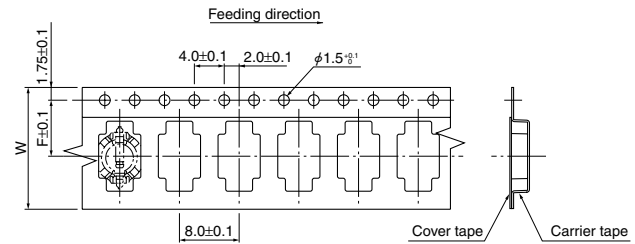

PB-518SR13-TF
PB-518SW13-TF

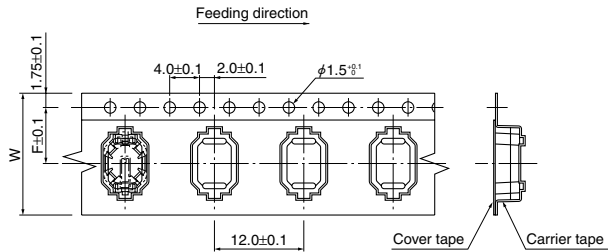

PB-614S13-TF

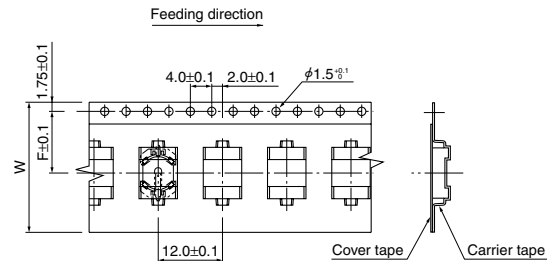

PB-614SS13-TF

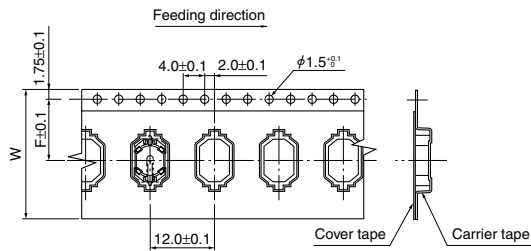

PB-621SR13-TF

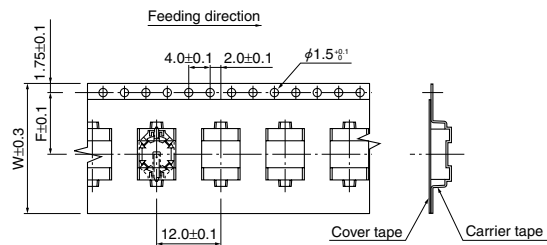

Model No.	Taping dimensions (mm)		Reel dimensions (mm)		Q'ty/ reel
	F	W	W1	W2	
PB-414SR12K-TF	7.5	16.0	16.4	330	3,000
PB-414SS12-TF	7.5	16.0	16.4	330	3,000
PB-518SR13-TF	7.5	16.0	16.4	380	2,000
PB-518SW13-TF	7.5	16.0	16.4	380	2,000
PB-614S13-TF	11.5	24.0	24.4	380	2,000
PB-614SS13-TF	11.5	24.0	24.4	330	2,000
PB-621SR13-TF	11.5	24.0	24.4	380	2,000

Note:

- Specifications conform to JIS C 0806. The tape width, connector loading recess square hole dimensions, etc. are determined by the number of circuits and external shape of the connector to be loaded.
- Specifications are subject to change without prior notice.