

Solderless splices

BUTT

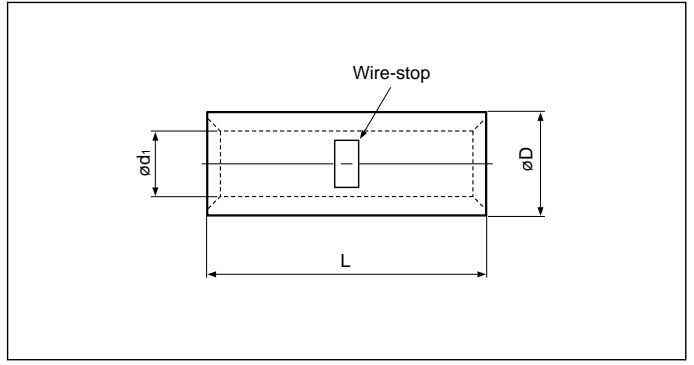

Actual

Refer to page 151 for actual size of the splice.

Non-insulated

File No.: E42024 LR20812

Applicable Wire AWG#(mm ²)	Part No.	Standard	Dimensions mm (in.)			Tool No.												Qty/box										
			L	ø D	ø d1	YHT-2210	YHT-8S	YA-1	YA-2	YA-4	YA-5	YPT-60N	YPT-150-1	BCT-0514	BCT-860N	BCT-8150	YET-60-1			YET-150-1	YET-300-1	YET-300N						
22 to 16 (0.25 to 1.65)	C-1.25		15.0 (.591)	3.3 (.130)	1.7 (.067)	0	0	0	0				0															1,000
16 to 14 (1.04 to 2.63)	C-2		15.0 (.591)	4.1 (.161)	2.3 (.091)	0		0	0	0			0															1,000
12 to 10 (2.63 to 6.64)	C-5.5		15.0 (.591)	5.4 (.213)	3.4 (.134)	0		0	0	0			0															500
8 (6.64 to 10.52)	C-8		21.0 (.827)	7.0 (.276)	4.5 (.177)		0			0	0	0	0	0	0	0	0	0	0	0								200
6 (10.52 to 16.78)	C-14		26.0(1.024)	8.9 (.350)	5.8 (.228)					0	0	0	0	0	0	0	0	0	0	0								100
4 (16.78 to 26.66)	C-22		29.0(1.142)	11.3 (.445)	7.7 (.303)						0	0	0															100
2 (26.66 to 42.42)	C-38		32.0(1.260)	13.2 (.520)	9.4 (.370)							0	0	0														50
1/0 (42.42 to 60.57)	C-60		36.0(1.417)	15.3 (.602)	11.4 (.449)								0	0	0								0	0	0	0	0	25
2/0 (60.57 to 76.28)	C-70		37.0(1.457)	17.5 (.689)	13.3 (.524)									0										0	0	0	0	25
3/0 (76.28 to 96.3)	C-80		38.0(1.496)	19.5 (.768)	14.5 (.571)										0									0	0	0	0	20
4/0 (96.3 to 117.2)	C-100		38.0(1.496)	22.1 (.870)	16.4 (.646)											0								0	0	0	0	10
250 to 300MCM (117.2 to 152.05)	C-150		54.0(2.126)	26.4(1.039)	19.5 (.768)										0										0	0	0	10
350MCM (152.05 to 192.6)	C-180		57.0(2.244)	28.5(1.122)	21.0 (.827)																				0	0	0	10
400MCM (192.6 to 242.27)	C-200		63.0(2.480)	32.4(1.276)	24.0 (.945)																				0	0	0	10
600 to 650MCM (242.27 to 325)	C-325		72.0(2.835)	37.0(1.457)	28.0(1.102)																				0	0	0	10

Note:1) Delivery lead times may vary depending on the product. Contact JST for details.

Vinyl

Nylon

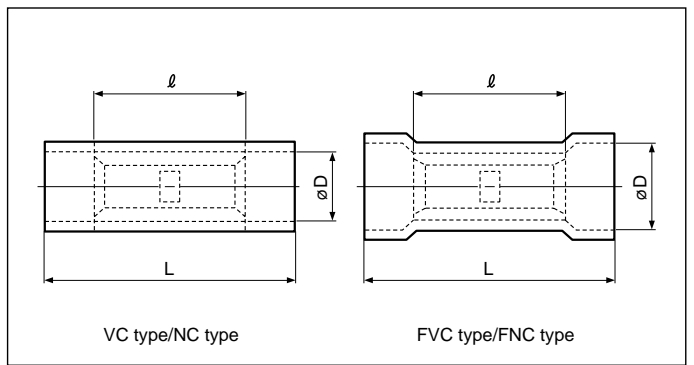
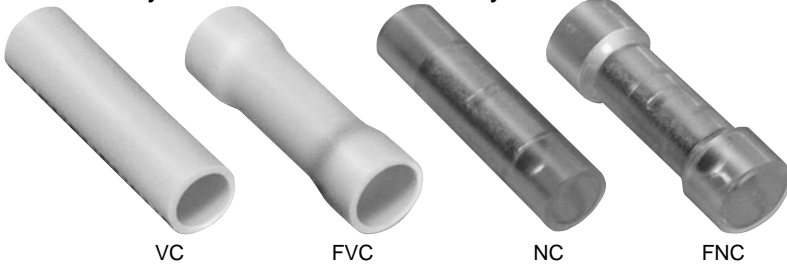

Actual

Refer to page 152 for actual size of the splice.

Vinyl or nylon insulated

File No.: E42024 LR20812

Applicable Wire AWG#(mm ²)	Part No.		Standard	Dimensions mm (in.)			Color	Tool No.						Qty/box		
	Vinyl	Nylon		L	ℓ	øD		YNT-2216	YNT-1614	YNT-1210S	YA-1	YA-2	YA-4	BCT-0514	Vinyl	Nylon
22 to 16 *(0.25 to 1.65)	VC-1.25	NC-1.25		22.7 (.894)	15.0 (.591)	3.2 (.126)	Red	0		0	0	0	0		1,000	500
	FVC-1.25	FNC-1.25				4.0 (.157)										
16 to 14 (1.04 to 2.63)	VC-2	NC-2		22.7 (.894)	15.0 (.591)	3.9 (.154)	Blue		0	0	0	0		1,000	500	
	FVC-2	FNC-2				4.5 (.177)										
12 to 10 (2.63 to 6.64)	VC-5.5	NC-5.5		26.7(1.051)	15.0 (.591)	5.4 (.213)	Yellow		0		0	0		500	500	
	FVC-5.5	FNC-5.5				6.8 (.268)										

Note:1) *The crimping will be more secure if the total cross-sectional area of the wire is at least 0.5 mm².

Examples: If the cross-sectional area of the wire is 0.3mm², fold the wire in two when crimping the terminal.

If the cross-sectional area of the wire is 0.5mm², crimp the terminal onto the wire as it is.

2) Delivery lead times may vary depending on the product. Contact JST for details.

BUTT

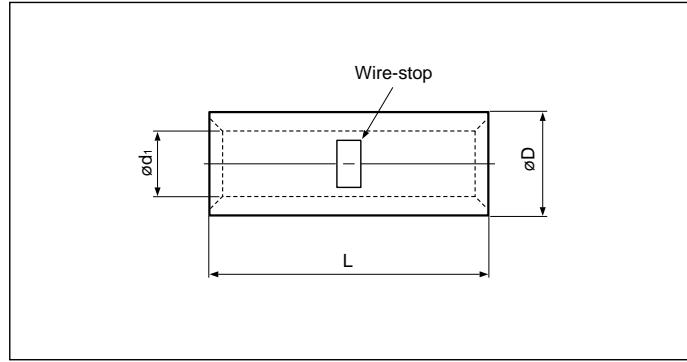
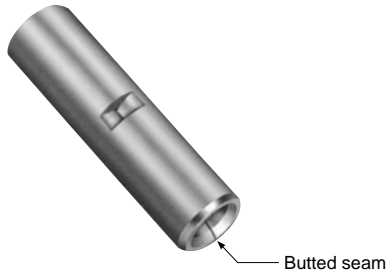

Non-insulated

Applicable Wire AWG# (mm ²)	Part No.	Standard	Dimensions mm (in.)			Tool No.					Qty/box
			L	ø D	ø d ₁	YHT-2210	YA-1	YA-2	YA-4	BCT-0514	
22 to 16 (0.25 to 1.65)	WSC-1.25		15.0 (.591)	3.3 (.130)	1.7 (.067)	0	0	0	0	0	1,000
16 to 14 (1.04 to 2.63)	WSC-2		15.0 (.591)	4.0 (.157)	2.3 (.091)	0	0	0	0	0	
12 to 10 (2.63 to 6.64)	WSC-5.5		15.0 (.591)	5.5 (.217)	3.4 (.134)	0	0	0	0	0	

Note:1) These products have a butted seam.

2) Delivery lead times may vary depending on the product. Contact JST for details.

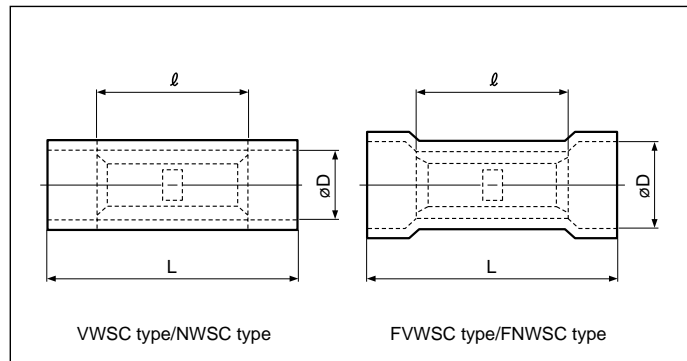
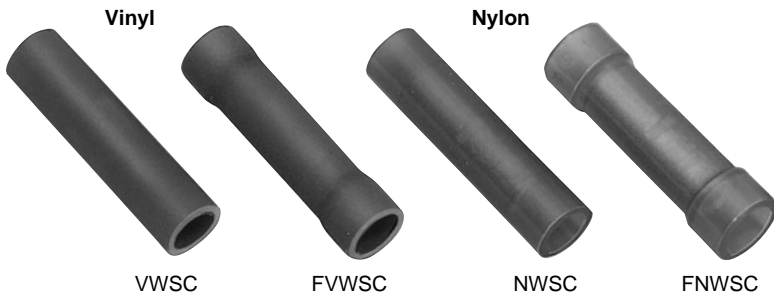

Vinyl or nylon insulated

Applicable Wire AWG# (mm ²)	Part No.		Standard	Dimensions mm (in.)			Color	Tool No.					Qty/box		
	Vinyl	Nylon		L	ℓ	ø D		YMT-2216	YMT-1614	YMT-1210S	YA-1	YA-2	YA-4	BCT-0514	Vinyl
22 to 16 *(0.25 to 1.65)	VWSC-1.25	NWSC-1.25		22.7 (.894)	15.0 (.591)	3.2 (.126)	0			0	0	0	0	1,000	500
	FWWSC-1.25	FNWSC-1.25				4.0 (.157)									
16 to 14 (1.04 to 2.63)	VWSC-2	NWSC-2		22.7 (.894)	15.0 (.591)	3.9 (.154)	0		0	0	0	0	1,000	500	
	FWWSC-2	FNWSC-2				4.5 (.177)									
12 to 10 (2.63 to 6.64)	VWSC-5.5	NWSC-5.5		26.7(1.051)	15.0 (.591)	5.4 (.213)	0		0	0	0	0	500	500	
	FWWSC-5.5	FNWSC-5.5				6.8 (.268)									

Note:1) These products have a butted seam.

2) *The crimping will be more secure if the total cross-sectional area of the wire is at least 0.5 mm².

Examples: If the cross-sectional area of the wire is 0.3mm², fold the wire in two when crimping the terminal.

If the cross-sectional area of the wire is 0.5mm², crimp the terminal onto the wire as it is.

3) Delivery lead times may vary depending on the product. Contact JST for details.