

# WINDOW TYPE BUTT

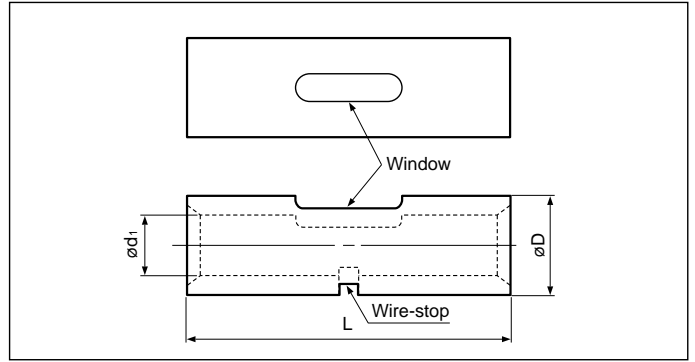

Actual

Refer to page 153 for actual size of the splice.



## Non-insulated

Applicable Wire AWG#(mm <sup>2</sup> )	Part No.	Standard	Dimensions mm (in.)			Tool No.												Qty/box						
			L	ø D	ø d <sub>1</sub>	YHT-2210	YHT-8S	YA-1	YA-2	YA-4	YA-5	YPT-60N	YPT-150-1	BCT-0514	BCT-860N	BCT-8150	YET-40-1		YET-150-1	YET-300-1	YF-1	E-4		
22 to 16 (0.25 to 1.65)	CW-1.25		14.7 (.579)	3.3 (.130)	1.7 (.067)	0	0	0	0					0										
16 to 14 (1.04 to 2.63)	CW-2		14.7 (.579)	4.0 (.157)	2.3 (.091)	0		0	0	0				0										
12 to 10 (2.63 to 6.64)	CW-5.5		14.7 (.579)	5.5 (.217)	3.4 (.134)	0		0	0	0				0										
8 (6.64 to 10.52)	CW-8		21.0 (.827)	7.1 (.280)	4.5 (.177)		0			0	0	0	0	0	0	0	0	0	0	0	0	0	0	0
6 (10.52 to 16.78)	CW-14		26.0(1.024)	9.0 (.354)	5.8 (.228)					0	0	0	0	0	0	0	0	0	0	0	0	0	0	0
4 (16.78 to 26.66)	CW-22		29.0(1.142)	11.4 (.449)	7.7 (.303)						0	0	0		0	0	0	0	0	0	0	0	0	0
2 (26.66 to 42.42)	CW-38		32.0(1.266)	13.3 (.524)	9.4 (.370)							0	0	0		0	0	0	0	0	0	0	0	0
1/0 (42.42 to 60.57)	CW-60		36.0(1.417)	15.4 (.606)	11.4 (.449)								0	0	0		0	0	0	0	0	0	0	0
2/0 (60.57 to 76.28)	CW-70		37.0(1.457)	17.5 (.689)	13.3 (.524)									0		0	0	0	0	0	0	0	0	0
3/0 (76.28 to 96.3)	CW-80		38.0(1.496)	19.4 (.764)	14.5 (.571)										0	0	0	0	0	0	0	0	0	0
4/0 (96.3 to 117.2)	CW-100		38.0(1.496)	22.0 (.866)	16.4 (.646)											0	0	0	0	0	0	0	0	0
250 to 300MCM (117.2 to 152.05)	CW-150		54.0(2.126)	26.5(1.043)	19.5 (.768)												0	0	0	0	0	0	0	0
350MCM (152.05 to 192.6)	CW-180		57.0(2.244)	28.5(1.122)	21.0 (.827)																	0	0	0
400MCM (192.6 to 242.27)	CW-200		63.0(2.480)	32.5(1.280)	24.0 (.945)																	0	0	0
600 to 650MCM (242.27 to 325)	CW-325		72.0(2.835)	37.0(1.457)	28.0(1.102)																	0	0	0

Note:1) Delivery lead times may vary depending on the product. Contact JST for details.

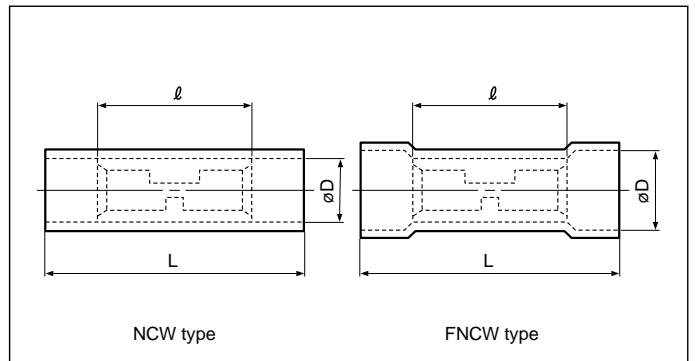
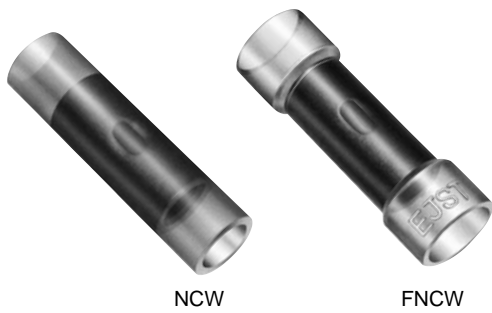

## Nylon-insulated

Applicable Wire AWG#(mm <sup>2</sup> )	Part No.	Standard	Dimensions mm (in.)			Color	Tool No.						Qty/box	
			L	l	ø D		YNT-2216	YNT-1614	YNT-1210S	YA-1	YA-2	YA-4		BCT-0514
22 to 16 *(0.25 to 1.65)	NCW-1.25		22.7 (.894)	14.7 (.579)	3.2 (.126)	Red (Clear)	0			0	0	0	0	0
	FNCW-1.25	4.0 (.157)												
16 to 14 (1.04 to 2.63)	NCW-2		22.7 (.894)	14.7 (.579)	3.9 (.154)	Blue (Clear)	0			0	0	0	0	0
	FNCW-2	4.5 (.177)												
12 to 10 (2.63 to 6.64)	NCW-5.5		26.7(1.051)	14.7 (.579)	5.4 (.213)	Yellow (Clear)			0			0	0	0
	FNCW-5.5	6.8 (.268)												

Note:1) \*The crimping will be more secure if the total cross-sectional area of the wire is at least 0.5 mm<sup>2</sup>.  
 Examples: If the cross-sectional area of the wire is 0.3mm<sup>2</sup>, fold the wire in two when crimping the terminal.  
 If the cross-sectional area of the wire is 0.5mm<sup>2</sup>, crimp the terminal onto the wire as it is.  
 2) The insulation is colored transparent nylon so that the wire inside the sleeve is visible.  
 3) Delivery lead times may vary depending on the product. Contact JST for details.

# WINDOW TYPE BUTT

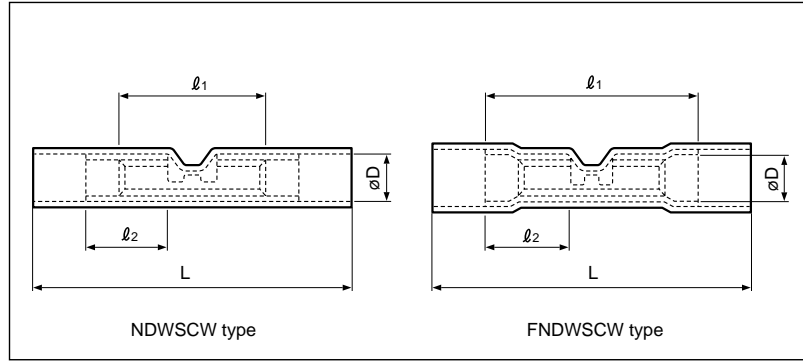
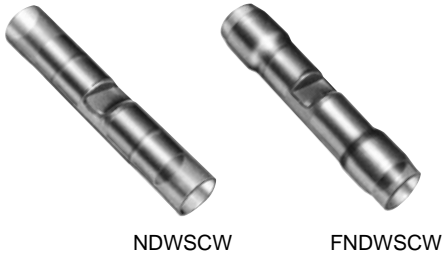

## Nylon-insulated with copper sleeve

Applicable Wire AWG# (mm <sup>2</sup> )	Part No.	Standard	Dimensions mm (in.)				Color	Tool No.							Qty/box
			L	l <sub>1</sub>	ø D	l <sub>2</sub>		YNT-2216	YNT-1614	YNT-1210S	YA-1	YA-2	YA-4	BCT-0514	
22 to 16 * (0.25 to 1.65)	NDWSCW-1.25		31.5 (1.240)	14.6 (.575)	3.5 (.138)	8.3 (.327)	Red (Clear)	0			0	0	0	0	1,000
	FNDWSCW-1.25		31.0 (1.220)	14.6 (.575)	4.0 (.157)	12.2 (.480)									
16 to 14 (1.04 to 2.63)	NDWSCW-2		31.5 (1.240)	14.6 (.575)	4.1 (.161)	8.3 (.327)	Blue (Clear)		0		0	0	0	0	1,000 500
	FNDWSCW-2		31.0 (1.220)	14.6 (.575)	4.7 (.185)	12.2 (.480)									
12 to 10 (2.63 to 6.64)	NDWSCW-5.5		41.1 (1.618)	19.5 (.768)	5.7 (.224)	12.0 (.472)	Yellow (Clear)			0			0	0	500 250
	FNDWSCW-5.5		36.0 (1.417)	19.5 (.768)	6.5 (.256)	14.3 (.563)									

Note: 1) These products have a butted seam.

2) \*The crimping will be more secure if the total cross-sectional area of the wire is at least 0.5 mm<sup>2</sup>.

Examples: If the cross-sectional area of the wire is 0.3mm<sup>2</sup>, fold the wire in two when crimping the terminal.

If the cross-sectional area of the wire is 0.5mm<sup>2</sup>, crimp the terminal onto the wire as it is.

3) Delivery lead times may vary depending on the product. Contact JST for details.